

N.B. POCKETS FOR VOLLEY BALL NET TO BE CORE DRILLED INTO LOCATION TO POLE SUPPLIERS SPECIFICATION AND DETAIL ACCORDING TO COURT DIMENSIONS.

E.J = EXPANSION JOINT  
C.J = CONSTRUCTION JOINT

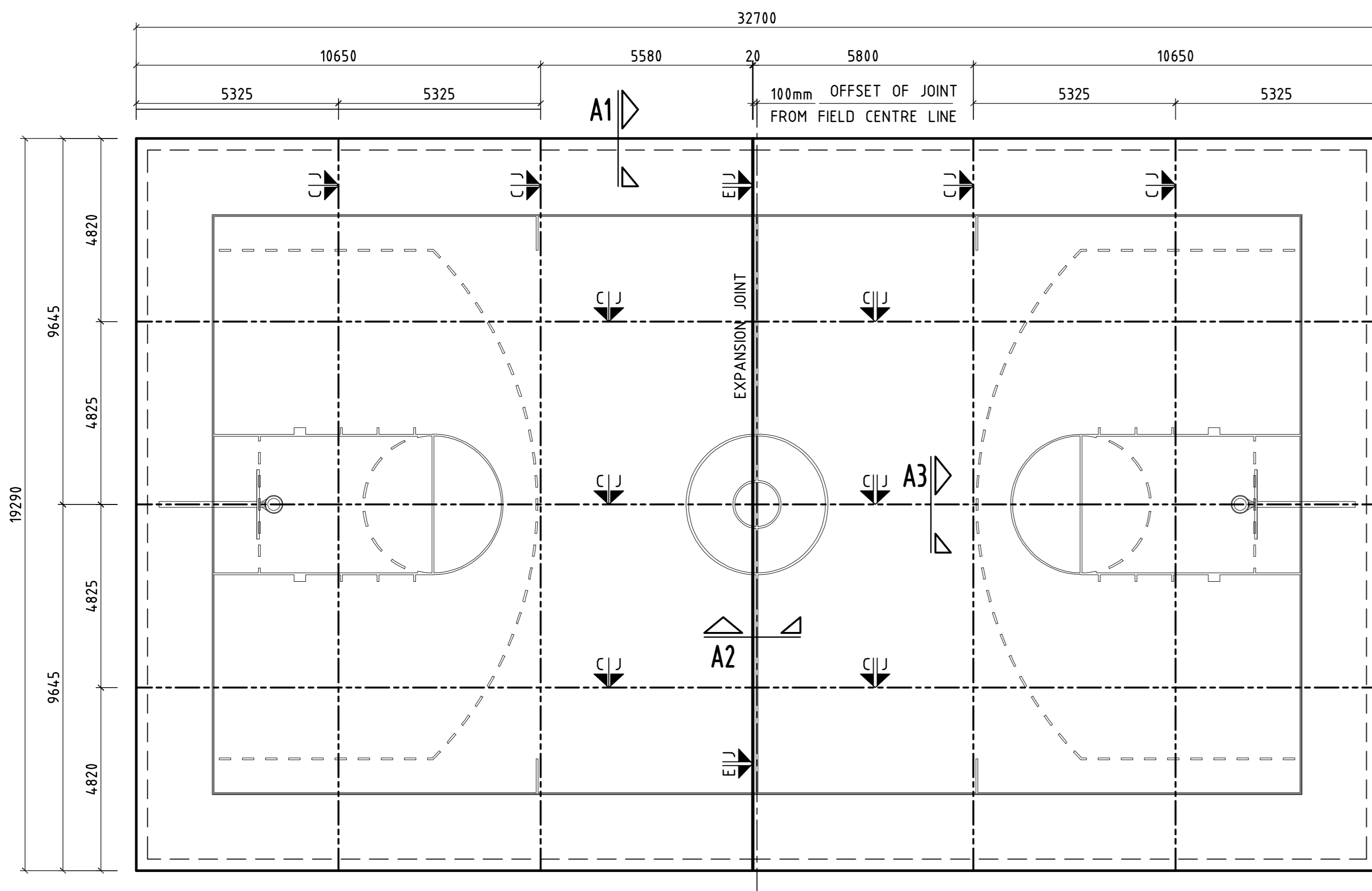

COMBI COURT CONCRETE SLAB JOINTS - LAYOUT PLAN  
SCALE 1:10

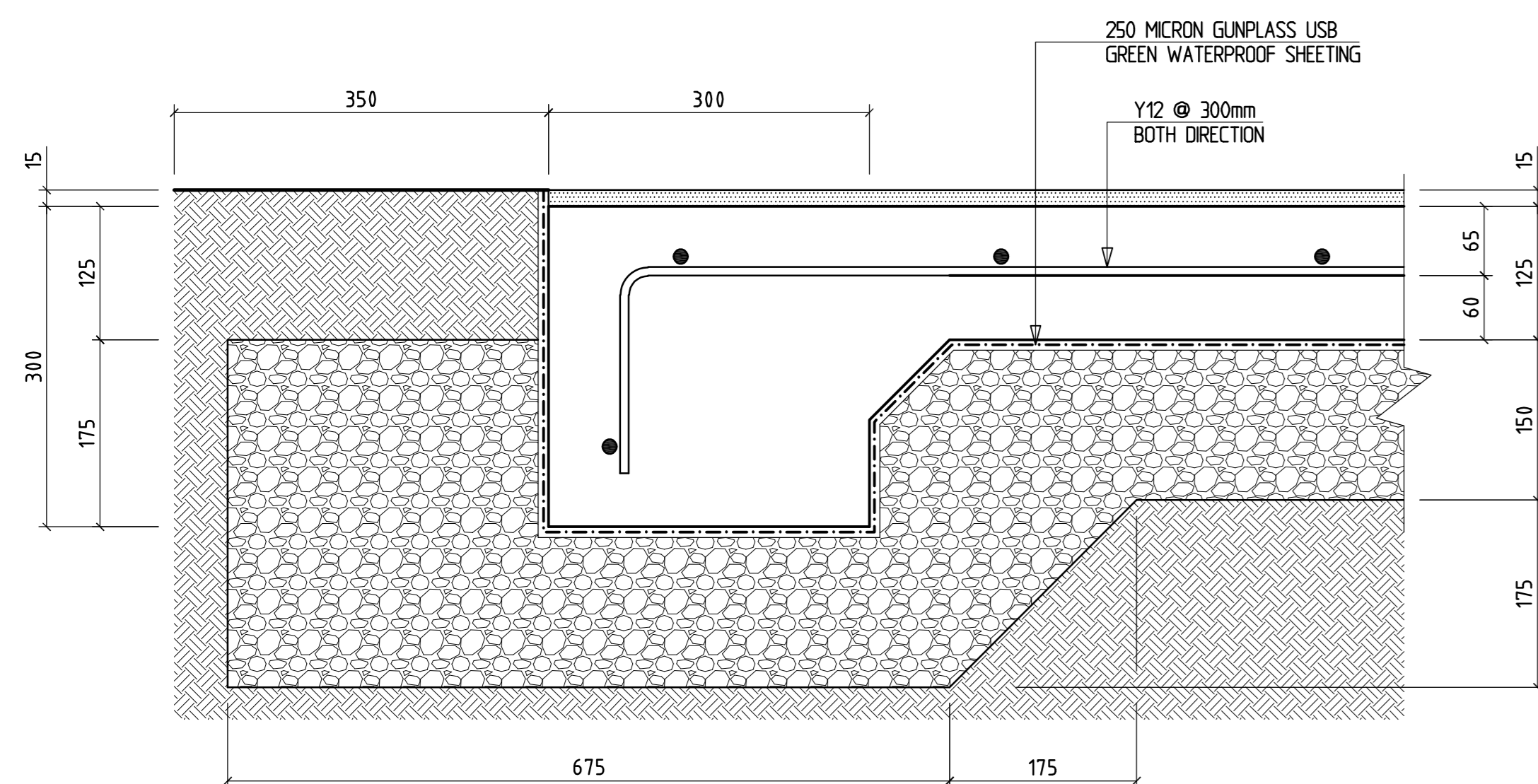

THICKENED COMBI COURT EDGE  
SECTION - A1 (TYPICAL)  
SCALE 1:5

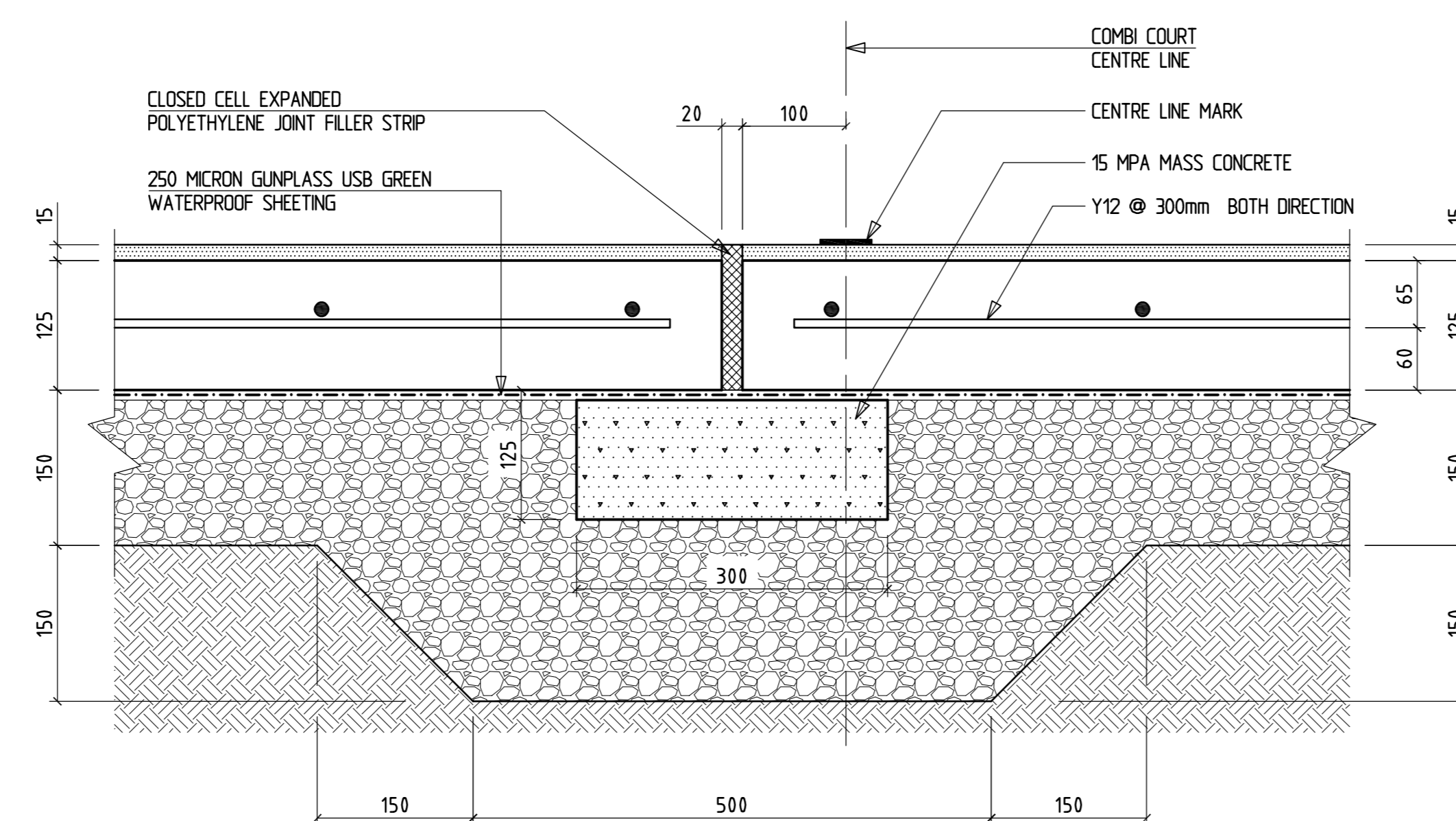

COMBI COURT EXPANSION JOINT  
SECTION - A2  
SCALE 1:5

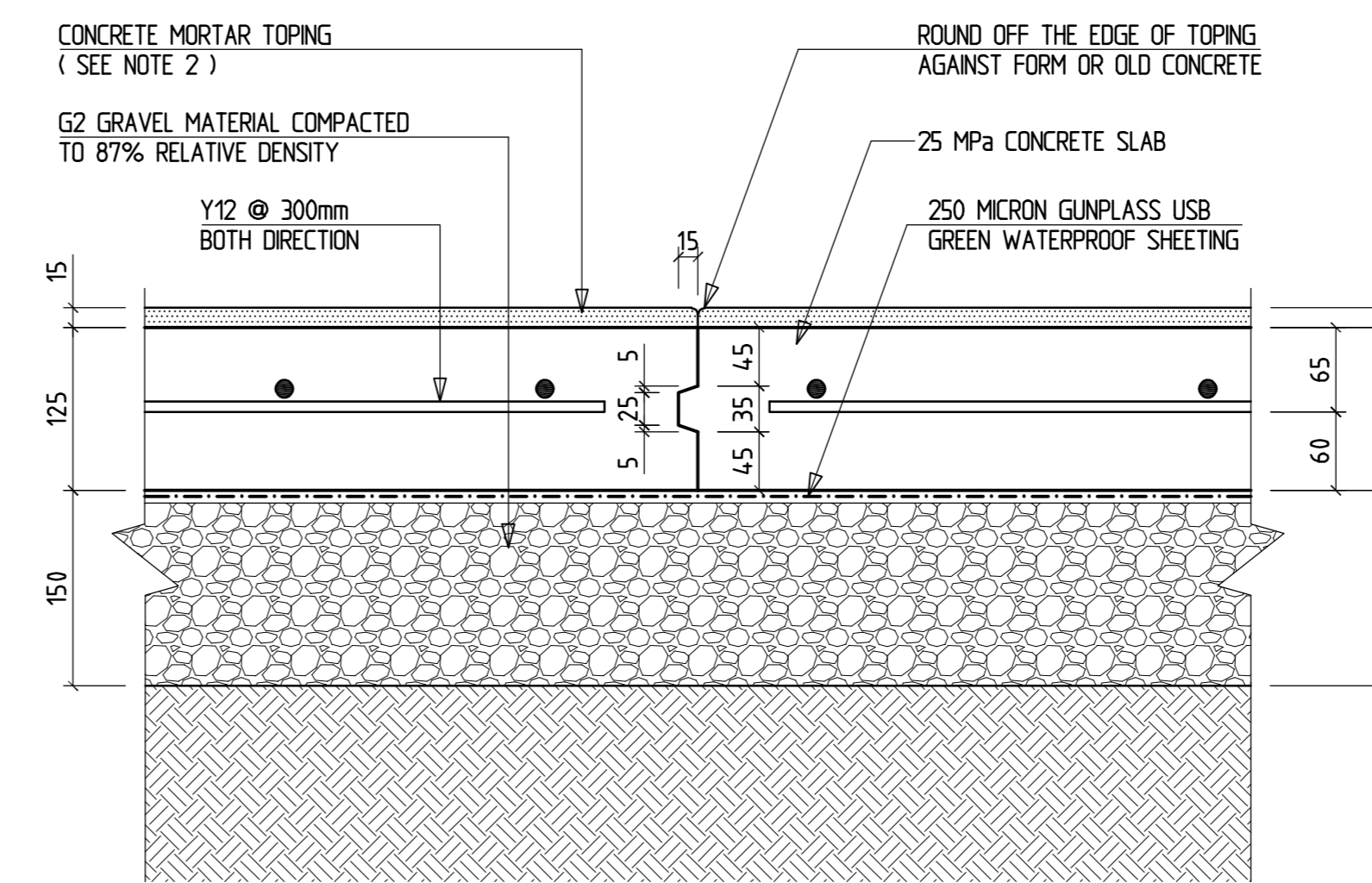

COMBI COURT KEYED CONTRACTION JOINT  
SECTION - A3 (TYPICAL)  
SCALE 1:5

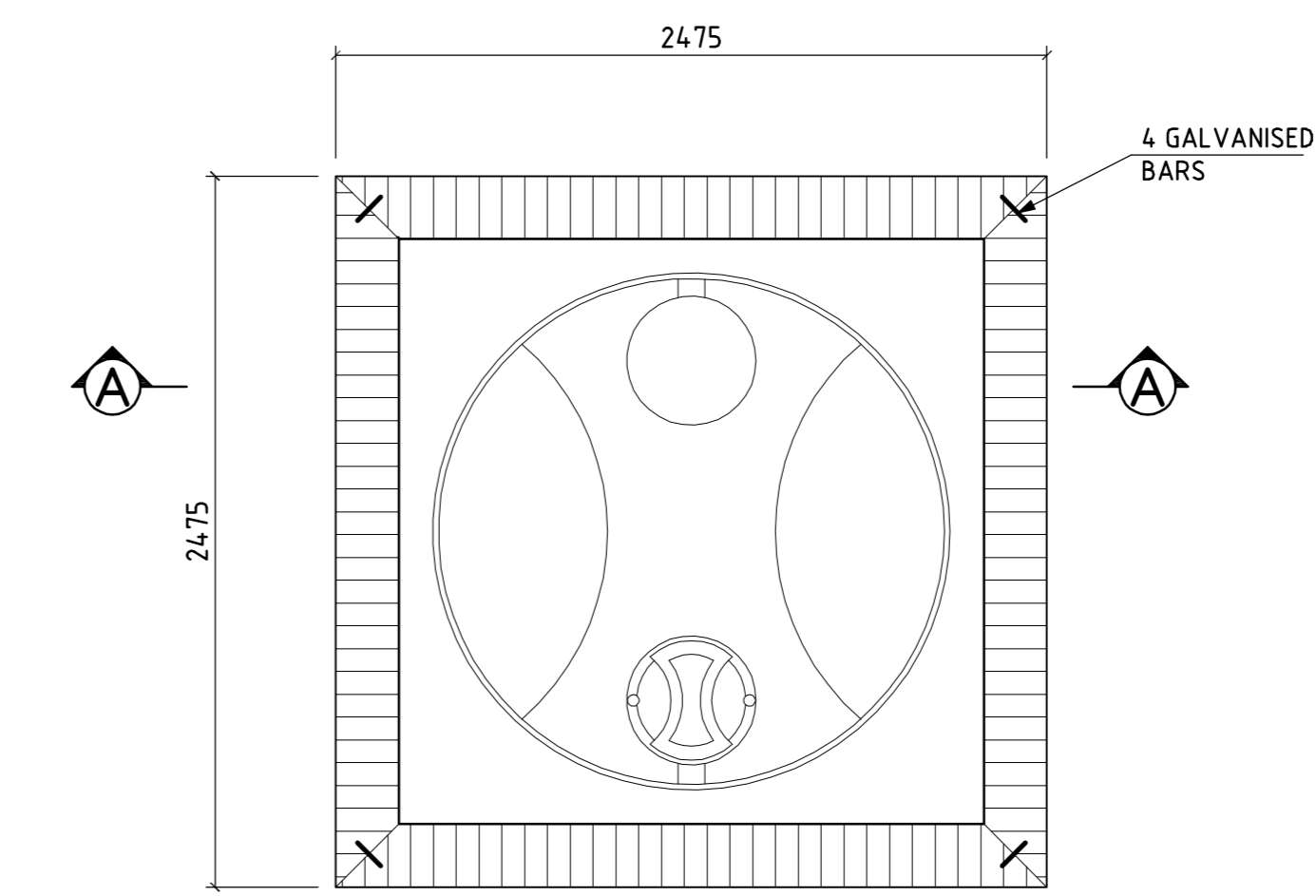

RAIN WATER STORAGE TANK  
TOP SLAB - PLAN  
SCALE 1:25

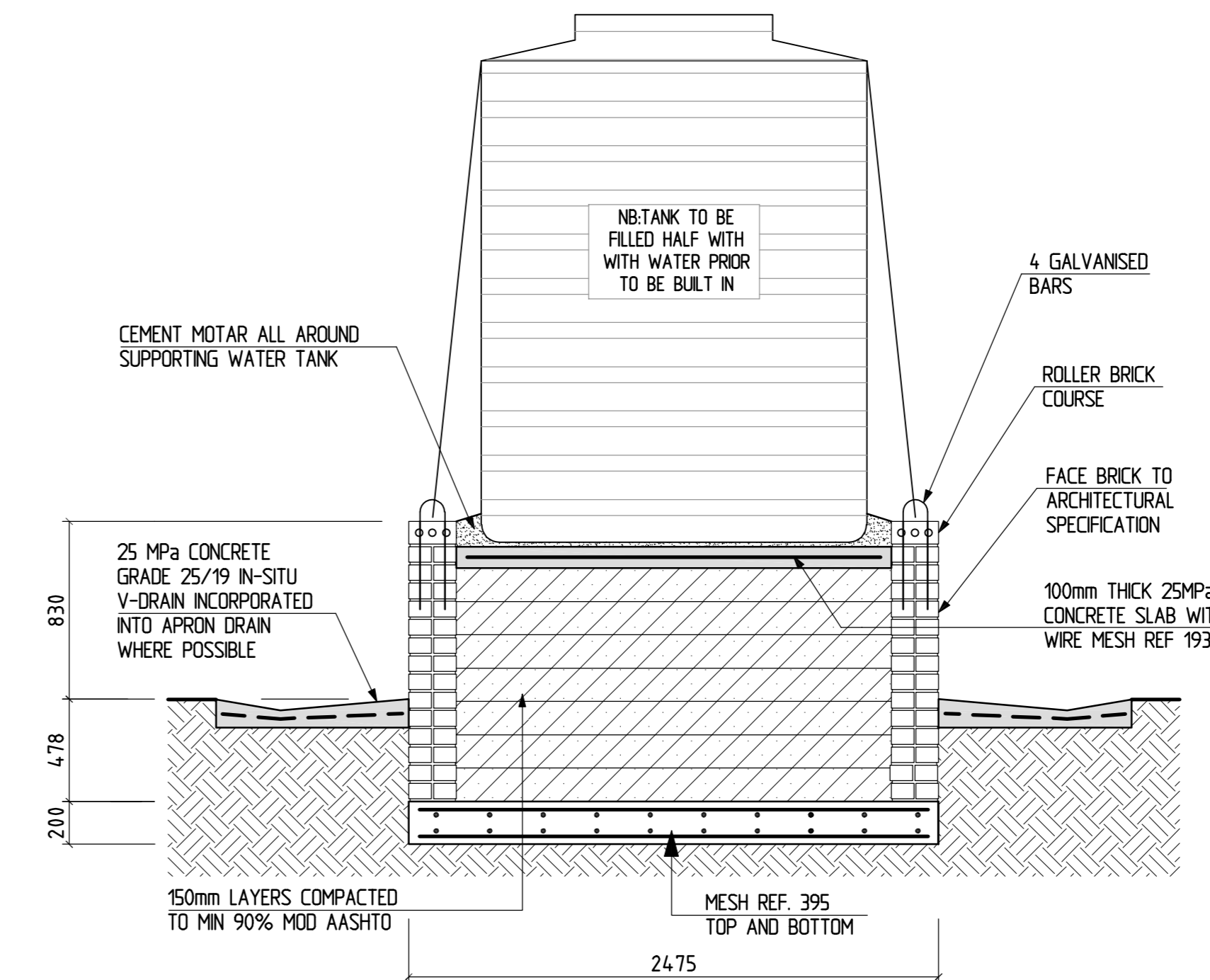

RAIN WATER STORAGE TANK  
SECTION A-A  
SCALE 1:25

NOTES TO COMBI COURT CONCRETE SLAB

- THE EARTHWORKS FINISH LEVEL SHALL BE TRIMMED AND COMPACTED TO APPROPRIATE LEVEL SO THAT THE CONCRETE SLAB IS FINISHED TO THE CORRECT LEVEL AND GRADE TO CIVIL ENGINEER'S SPECIFICATION
- LAYERWORKS:**  
SURFACE : 15mm THICK CONCRETE MORTAR TOPPING CONSISTING OF 1 BAG OF CEMENT AND 100 LITRES OF SAND MIXED WITH JUST SUFFICIENT WATER TO GIVE PLASTIC CONSISTENCY SIMILAR TO THAT USED FOR PLASTERING.  
BASE : 125mm THICK 25MPa REINFORCED CONCRETE SLAB, REINFORCED WITH 12mm DIAMETER HIGH TENSILE STEEL SPACED AT 300mm CENTERS IN BOTH DIRECTION. BOTTOM REINFORCEMENT SHALL HAVE 60mm COVER FROM THE BOTTOM OF THE BASE. THE CONCRETE BASE SHALL BE LAID ON 250 MICRON GUNGLASS USB GREEN WATERPROOF SHEETING  
SUB-BASE : 150mm THICK G2 GRAVEL MATERIAL COMPACTED TO 87% RELATIVE DENSITY.  
SUBGRADE : ENGINEERING FILL MATERIAL TRIMMED AND COMPACTED TO 93% MODIFIED AASHTO DENSITY.
- GREEN WATERPROOF SHEETING SHALL BE INSTALLED PRIOR TO INSTALLATION OF ANY STEEL AND/OR CABLES. OVERLAP WATERPROOF SHEETS AT LEAST 200mm AND TAPE THE JOINTS. ONCE IN PLACE NO VEHICULAR TRAFFIC SHALL BE ALLOWED ON THE WATERPROOF SHEETING NOR ANY OTHER OBJECT WHICH COULD PUNCTURE THE BARRIER.
- EACH BAY OF CONCRETE SLAB DEMARCATED BY CONTRACTION AND/OR EXPANSION JOINT SHALL BE CAST IN ONE CONTINUOUS OPERATION, PREFERABLY IN THE AFTERNOON UNDER COOLER TEMPERATURES.
- EXPANSION JOINT** AN EXPANSION JOINT PROVIDED ACROSS THE COURT NEAR THE CENTERLINE CONSISTS OF 20 mm WIDE GAP CONTAINING A STRIP OF CLOSED CELL EXPANDED POLYETHYLENE.
- CONTRACTION JOINT** CONTRACTION JOINTS SHALL BE KEYED. WHEN A BAY OF CONCRETE IS TO BE CAST AGAINST COMPLETED WORK, THE NEW CONCRETE SHALL BE PLACED TO BUTT DIRECTLY AGAINST THE EDGE OF OLD CONCRETE
- A WORKING PLATFORM SPANNING OVER THE SLAB BAY UNDER CONSTRUCTION SHALL BE REQUIRED TO ENABLE WORKMEN TROWEL CONCRETE WITHOUT MARKING COMPLETED WORK.
- THE CONCRETE TOPPING SHALL BE PLACED DIRECTLY ON THE SURFACE OF THE BASE CONCRETE WITHIN ONE TO FOUR HOURS OF COMPLETING THE BASE CONCRETE. THE TOPPING SHALL BE PLACED WITH TAMPING AND LEVELED WITH A STRIKE-OFF BOARD
- IMMEDIATELY AFTER THE SURFACE HAS SUFFICIENTLY STIFFENED IT SHALL BE KEPT CONTINUOUSLY MOIST FOR 7 DAYS BY COVERING WITH POLYETHYLENE FILM, WATERPROOF CURING PAPER, SPRINKLING, PONDING OR OTHER ACCEPTABLE COVERINGS HELD DOWN WITH STONES OR OTHER WEIGHTS.

Notes:  
**MUNICIPAL CONNECTION**  
1. CONTRACTOR SHALL CONFIRM THE ACTUAL MUNICIPAL CONNECTION WITH THE ENGINEER AND THE MUNICIPALITY.

FOR TENDER  
ORIGINAL IN RED  
**ORIGINAL**  
SIGNED: [Signature] DATE: 11/07/2023

REFERENCE DRAWINGS	
Orig. No.	Description

Copyright vests in the Department of Education  
AS-BUILT DRAWINGS  
Controlled as-built drawings as per Controlled Drawing Archive AS-BUILT DRAWING REQUIREMENTS  
Name: \_\_\_\_\_  
Date: \_\_\_\_\_  
Professional Registration No.: \_\_\_\_\_

No.	DATE	AMENDMENT	Rev By
1	12-07-2023	ISSUED FOR TENDER	EMC

Cad File Name  
C501\_AJD\_TANK\_FOUNDATION\_AND\_CP88\_COURT\_Rev-1.dwg

Checked By Consultant  
EM CHRNA  
Name: [Signature] Professional Registration No. 20020093  
Date: 11-07-2023

**MOLEMO**  
CONSULTING ENGINEERS  
BLOCK E  
13 VILBERS DRIVE  
CLARENDON  
PIETERMARITZBURG, 4300.  
CELL: 082 714 4400  
Email: admin@molemo.co.za

P.O. BOX 995  
PIETERMARITZBURG  
5001  
TEL: 033 342 7963  
TEL: 033 342 2288

Discipline: **CIVIL AND STRUCTURAL**

**idt**  
INTEGRATED DESIGN TEAM  
BROADCAST HOUSE, 5550N STREET  
FOUNT GALE  
PRIVATE BAG 30275  
LIMBATA, 5100

Project  
DEPARTMENT OF EDUCATION  
EASTERN CAPE PROVINCE

CONSTRUCTION OF  
SIVE MALUTI SPECIAL SCHOOL  
PHASE 3 CEDARVILLE

Drawing Description  
SIVE MALUTI SPECIAL SCHOOL  
PHASE 3 CEDARVILLE  
COMBI COURT AND JOJO TANK  
PLAN AND SECTIONS

Drawn: A. SWENJU Date: 11-07-2023  
Scale: 1:250 Sheet Size: A0

Consultant Drawing Number  
IDT-EC-SM-PH3-C501 Revision: T01

DOW Drawing Number  
IDT-EC-SM-PH3-C501 Revision: T01

Stamped by Plans Approval Committee

IDT-EC-SM-PH3-C501 REV. 1