

**COPYRIGHT NOTE**

- THIS DRAWING IS SUBJECT TO COPYRIGHT AND MAY NOT BE REPRODUCED, IN WHOLE OR PART, OR IN ANY MANNER WHATSOEVER WITHOUT WRITTEN PERMISSION FROM THE ARCHITECT.
- ALL WORK TO BE CARRIED OUT STRICTLY IN ACCORDANCE WITH MUNICIPAL AND/OR LOCAL AUTHORITY REGULATIONS.
- DO NOT SCALE THIS DRAWING.
- FIGURED DIMENSIONS TO BE TAKEN IN PREFERENCE TO SCALING DRAWING.
- ALL RELEVANT DETAILS, LEVELS, AND DIMENSIONS TO BE CHECKED ON SITE PRIOR TO COMMENCEMENT OF WORK.
- ANY DISCREPANCIES TO BE BROUGHT TO THE ATTENTION OF THE ARCHITECT.

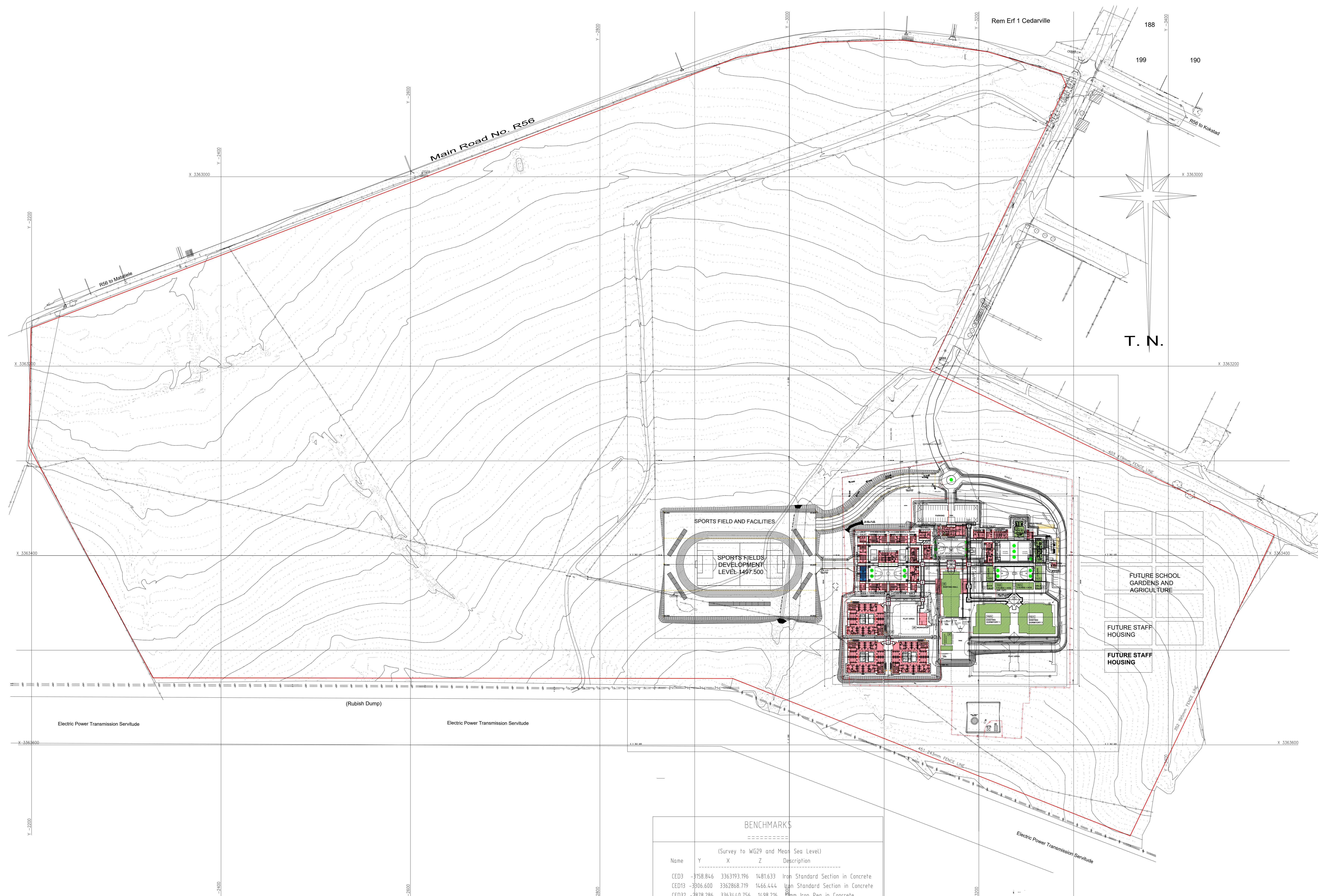

**BENCHMARKS**

=====

(Survey to WGS9 and Mean Sea Level)

Name	Y	X	Z	Description
CEED3	-158.846	3363193.196	1481.633	Iron Standard Section in Concrete
CEED13	-306.600	3362868.719	1466.444	Iron Standard Section in Concrete
CEED32	-2018.286	3363440.756	14.98.216	50mm Iron Peg in Concrete
CEED33	-2612.350	3362996.248	14.71.908	12mm Iron Peg in Concrete

REV	DATE	DESCRIPTION
A	01-01-2023	FOR ISSUE TO CONSULTANTS
B	18-01-2023	INCLUDE EDUCATION COMMENTS / UPDATE GENERAL DRAWING
C	14-02-2023	UPDATE BUILDING REF'S TO SUIT SITE INFO SET FOR TENDER PURPOSES
D	15-02-2023	UPDATE BUILDING REF'S TO SUIT SITE INFO SET FOR TENDER PURPOSES
E	29-08-2023	SET FOR TENDER PURPOSES

**MALUTI SPECIAL SCHOOL**

**PROPOSED NEW SPECIAL SCHOOL, CEDERVILLE, EASTERN CAPE PROVINCE**

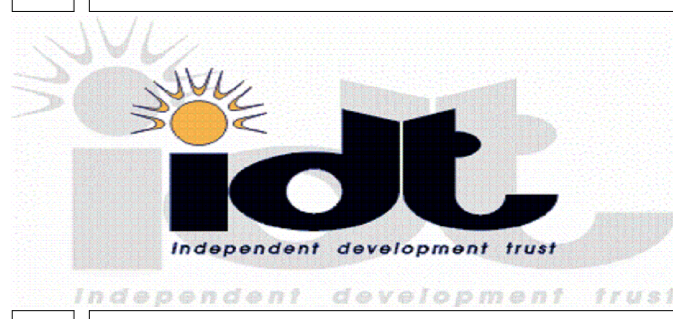

**MALUTI SPECIAL SCHOOL**

**SITE LOCATION PLAN**

**TENDER SET**

FORMA NUMBER	A2703_AR_TEN_0001	REVISION	E
DATE	08/12/11	SCALE	1:1500